

MRW-T8

Angle Fitting with Aluminium Reflector or Mattal Reflector

โคมกั้นฝาปกอลูมิเนียมสะท้อนแสง
หรือ ปีกเหล็กพ่นสีขาว

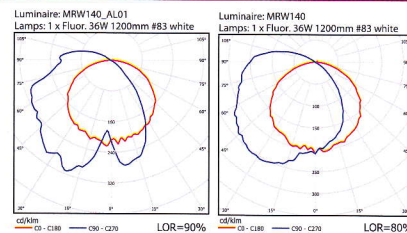

TIS.902-2532



TIS.1955-2551

SPECIFICATION

Housing :	Steel sheet thickness of 0.6-0.8 mm. And all metal parts are rust-proofed after fabrication to prevent any corrosion (zinc phosphate) and finished with high-grade epoxy polyester power coating.
Reflector :	Double side aluminium reflector 99.90% purity anodized aluminium reflector to provide total reflectance of TR 87-95% mirror-finish, parabolic reflectors machined to provide optimum optical performance for maximum high-output-ratio. Or Double side steel reflector with high-grade epoxy polyester power coating.
Lamp holder :	Rotary lock or spring load (G13) lamp holder certified by TIS NO.344-2549.
Starter holder :	Rotary lock certified by TIS NO.344-2549.
Wire :	Thw size 0.5-1.0 sqmm. 70 °c-105 °c certified by TIS NO.11-2531.

DRAWING

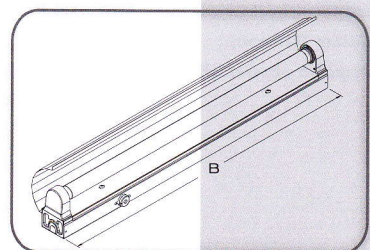
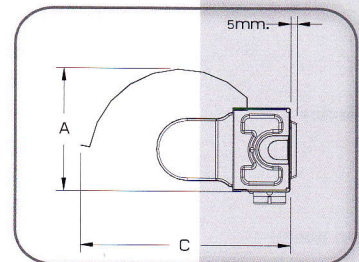

DIMENSION

Model No.	No. of Lamps	A (mm.)	B (mm.)	C (mm.)
MRW120	1 x 18w T8	80	613	110
MRW140	1 x 36w T8	80	1223	110
MRW120S	1 x 18w T8	80	635	110
MRW140S	1 x 36w T8	80	1245	110
MRW120-AL	1 x 18w T8	80	613	110
MRW140-AL	1 x 36w T8	80	1223	110
MRW120S-AL	1 x 18w T8	80	635	110
MRW140S-AL	1 x 36w T8	80	1245	110

Note: subject to +/- 2 mm in tolerance